

DISPENSERS ST 200 DC



EN. High flow rate portable dispenser unit. ST 200 dispenses diesel fuel at a rate of up to 185 l/min and controls the flow with great precision (+/- 1%) thanks to the oval-gear flow meter (on request).

ES. Unidad móvil de trasiego para caudal elevado. ST 200 suministra gasolina de hasta 185 l/min y controla el flujo con precisión (+/-1%) por medio del medidor mecánico con engranajes ovalados (a petición).

PT. Grupo distribuidor portátil de grande capacidade. O ST 200 distribui o combustível Diesel até 185 l/min e controla o fluxo com precisão (+/- 1%), graças ao conta-litros de engrenagens ovais (a pedido).

PERFORMANCE

- Flow rate up to 185 l/min
- Duty cycle 20 min ON / 40 min OFF
- Power supply 24 V DC

- Caudal hasta 185 l/min
- Ciclo de funcionamiento 20 min ON / 40 min OFF
- Alimentación 24V CC

- Caudal até 185 l/min
- Ciclo de trabalho 20 min ON / 40 min OFF
- Alimentação 24 V DC

DIMENSIONS

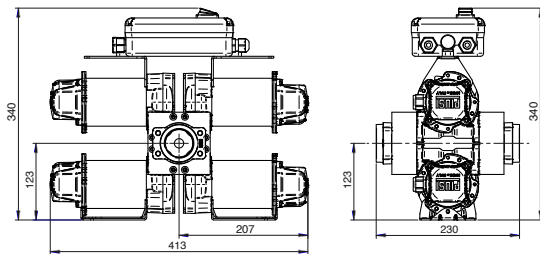

PRODUCTS' RANGE WEIGHT AND PACKAGING

| Code | Weight | | Packaging | | |
|-----------|--------|-----|-------------|----------------|---------|
| | kg | lbs | mm | inch | pcs/box |
| F00318000 | 18 | 40 | 480x370x265 | 18,9x14,6x10,4 | 1 |



Flow-rate

up to
185 l/min
(up to 48 gpm)



PIUSI[®]

DISPENSERS

PUMPS

METERS

NOZZLE METERS

NOZZLE

SPECIAL EQUIPMENTS

FLUID MONITORING

ACCESSORIES

FILTERING

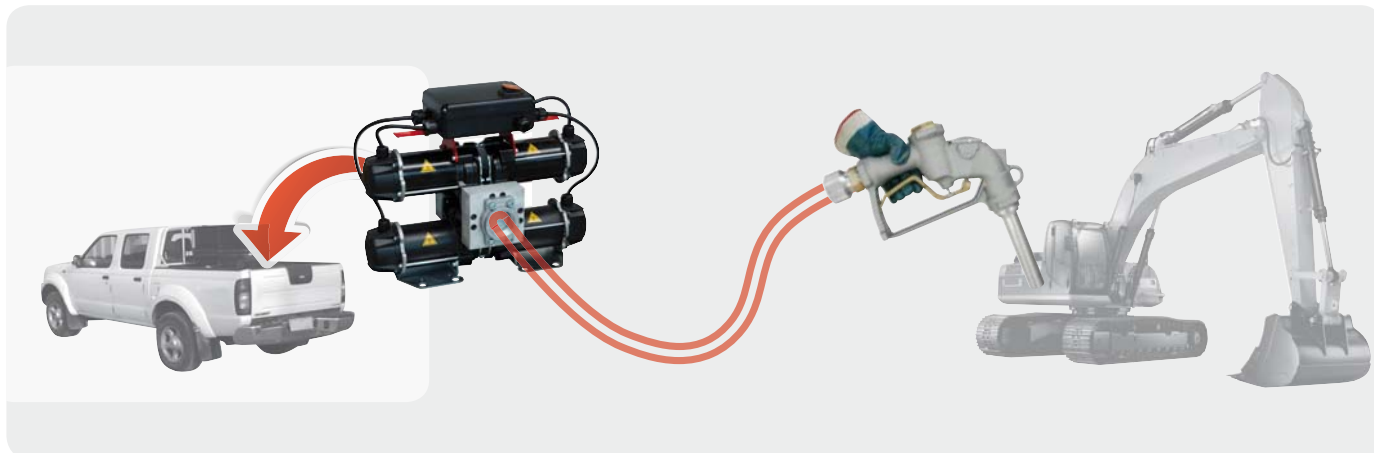
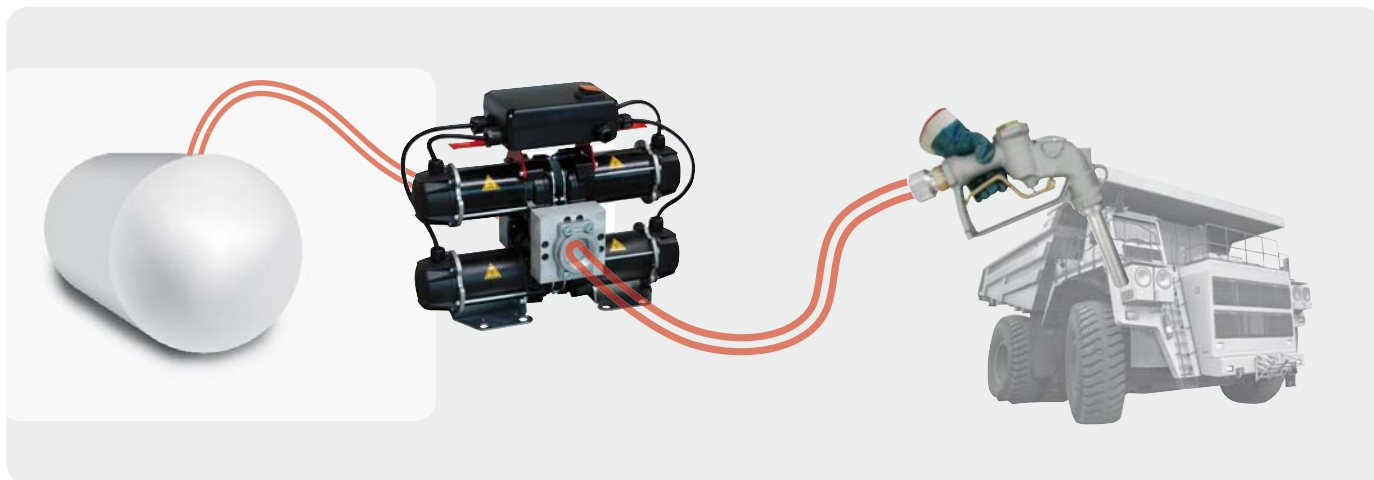

FEATURES

Electric cable



Electric cables with clamps (4 mt)

On/off switch



ON REQUEST

Meter K700 M



Flow rate:
20 -220 l/min
Accuracy: +/- 1%
Oval gear system
Code: F00540000

Nozzle A280



Fow rate 280 l/min
with swivel
Code: F13249000

Hose Kit 1" 1/2



Code: F18798000
(hose 10 mt + Camlock)
Code: F18799000
(hose 20 mt + Camlock)

PRODUCTS' RANGE TECHNICAL DATA

| Code | Description | Fluids type | Flow-rate | | Voltage | | | Duty cycle min. | Pump | | Max pressure bar | Inlet BSP |
|-----------|----------------|----------------|-----------|---------|---------------------|---------------|--------------|-----------------------|-------------|-----|------------------------|--------------|
| | | | l/min | gpm | AC V./Hz DC Volt | Power Watt | Amp. max. | | mod. | no. | | |
| F00318000 | ST 200 DC 24 V | D | 155-185 | 42 - 48 | 24 | 1200 | 50 | 30 | Bypass 3000 | 4 | 2 | 1" 1/2 |